

Incline Conveyor Hinged Plate Belt KFS-P 2040.86



» Hinged plate belt
with steel chain for
durable transport. «

With its compact conveyor frame made from aluminium profile technology, the KFS-P 2040.86 conveyor system is ideally suited for demanding continuous duty in multi-shift operation. The hinged plate belt is fully guided through wear strips and used for transporting stamped, cast, forged and wooden parts. With a gap of 1 to 3 mm between the chain and the side rail, this conveyor system is not suitable for pointed stamping scraps or metal chips.

The particularly robust steel chain is also available in a stainless steel or perforated design on request. It is suitable for transporting hot products. The conveyor system's modular design combined with the general advantages of profile technology make the conveyor excellently suited for integration into existing systems or for use as a mobile transport unit, e.g. for filling containers.

The slots in the profiles allow for easy connection of accessories such as side rails, stands, funnels and discharge slides. The use of standard components enables mk to achieve rapid delivery times and an excellent price-performance ratio. Custom solutions, such as special funnels, are available on request. Depending on the project you wish to convey, please also see our incline conveyor with a belt or modular belt.

Benefits of the KFS-P 2040.86

- Vertical transport for connecting different heights
- Stable and heat-resistant surface
- For transporting stamped, cast, forged or wooden parts and for hot product
- High load capacities available
- Transverse cleats for transporting small pieces or bulk product

Cross Section

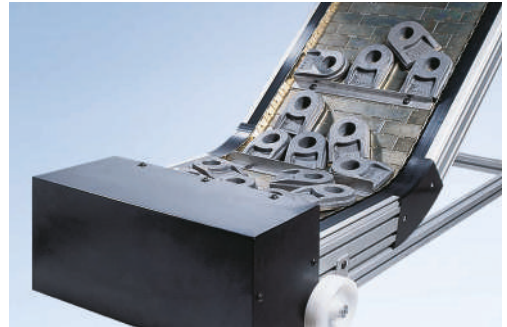
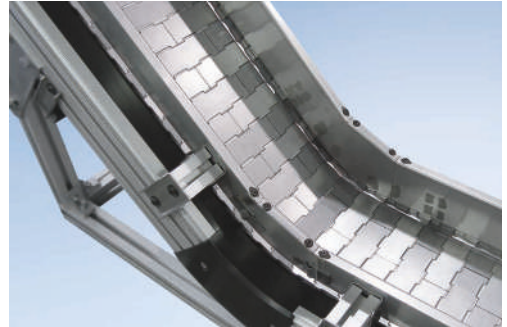
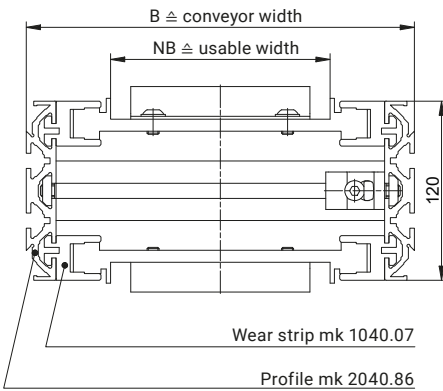

Properties

For the drive version AC, mk offers a multitude of drive motors tailored to various speed and load capacity requirements. The sprocket wheels ensure excellent transmission of the motor power.

3

Type S: B20.40.606, type K: B20.40.607, type L: B20.40.608, type G: B20.40.605

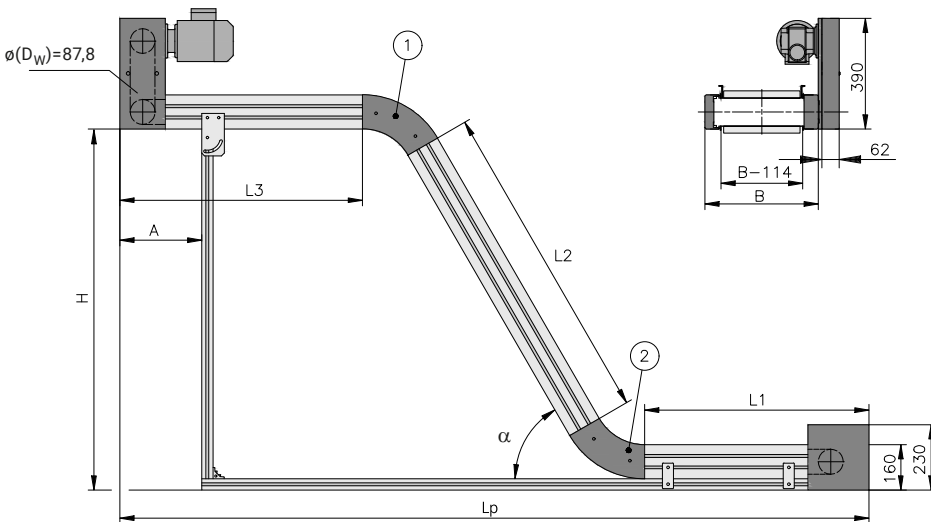

Technical data

Conveyor length L (L1+L2+L3)	depending on belt shape and load, up to 10000 mm	
Conveyor width B	210 to 710 mm (in 50 mm increments)	others on request
Drive location	discharge end left/right, underneath/above	
Drive and speed	up to 12 m/min	p. 12
Stand and side rail		from p. 140
Total load	up to 150 kg	p. 118
Distributed load	up to 50 kg/m, 15 kg/compartment	p. 118
Belt incline α 1 and 2	15, 30, 45 and 60°	others on request



Properties

The drive positioned laterally on the outside allows the total height of the conveyor to be restricted to a minimum. The sprocket wheel with the positive-locked connection to the modular belt ensures excellent transmission of the motor power.

3

Type S: B20.40.610, type K: B20.40.611, type L: B20.40.612, type G: B20.40.609

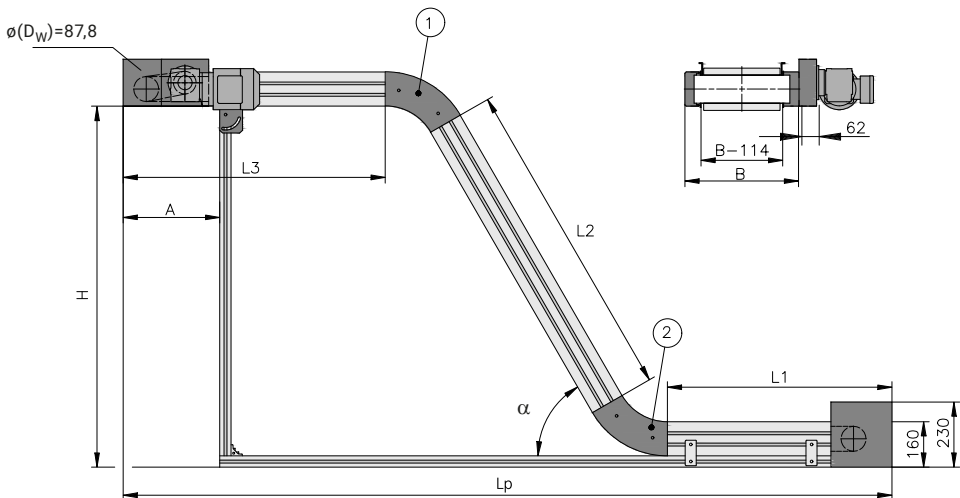

Technical data

Conveyor length L (L1+L2+L3)	depending on belt shape and load, up to 10000 mm	
Conveyor width B	210 to 710 mm (in 50 mm increments)	others on request
Drive location	discharge end left/right	
Drive and speed	up to 12 m/min	p. 12
Stand and side rail		from p. 140
Total load	up to 150 kg	p. 118
Distributed load	up to 50 kg/m, 15 kg/compartment	p. 118
Belt incline α 1 and 2	15, 30, 45 and 60°	others on request



KFS-P 2040.86

Stands

The stand type shown, stand type A, can be equipped with all the pad options. All the stands in the mk conveyor technology range can be used with type G.

The swivel casters used in pad option 1 have a total locking device and guarantee stability even at high transport speeds.

They are available as \varnothing 75 mm for $x=113$ mm, \varnothing 100 mm for $x=140$ mm and \varnothing 125 mm for $x=165$ mm.

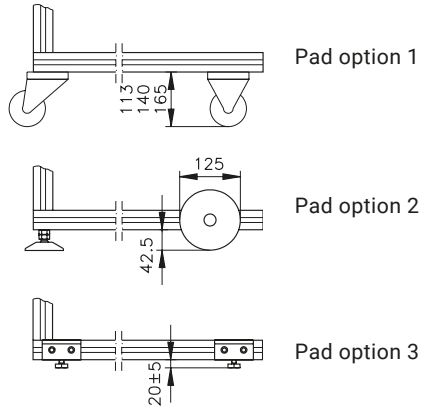
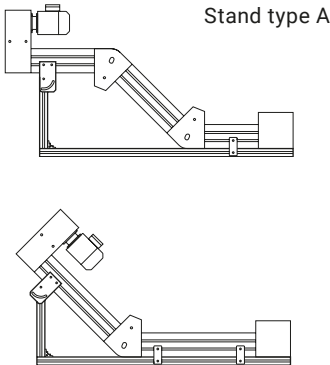

Sample order

KFS-P 2040.86 type S (B20.40.606)

- Drive AC 0° motor orientation (as shown)
- Speed of 10 m/min
- Conveyor width B = 460 mm
- Conveyor length
L1 = 500 mm; L2 = 1000 mm; L3 = 600 mm
- Belt incline α 1 = 60°; belt incline α 2 = 60°
- Cam height H1 = 20 mm (see page 133)
- Stand type A, pad option 1, \varnothing 75 mm roll
- Infeed height ELH = 200 mm
- Discharge height ALH = 1200 mm

Type designation

		Drive	AC	AS
Type S		B20.40. ...	606	610
Type K		B20.40. ...	607	611
Type L		B20.40. ...	608	612
Type G		B20.40. ...	605	609

Side Rail SF 8.1

B17.00.026

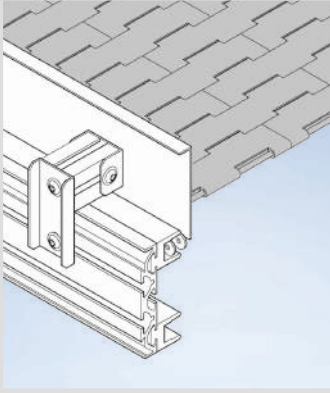

The side rails shown are our standard version and are available with rapid delivery times.

They seal the gap (up to 1–3 mm) between the chain and conveyor frame.

Height H=75 mm
 Height H=100 mm

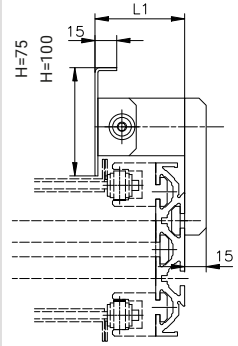



... for KFS-P 2040.86

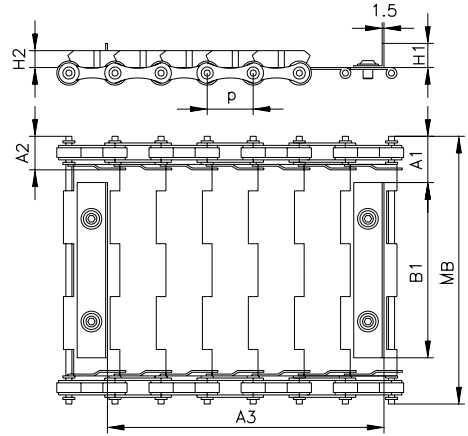

The particularly robust hinged plate belt is also available in a stainless steel or perforated design on request.

Hinged Plate Belt

SK1

A1 (without side plate/with side plate)	38.1 mm
A2	25 mm
MB	147–647 mm
Cam height H1	20/40 mm
Side plate height H2	14 mm
Cam spacing A3	38.1 mm in grid
Colour	Bright steel
Spacing p	38.1 mm
Chain thickness	13 mm
Material	Steel
FDA/USDA suitability	No
Technical properties	Steel Wear-resistant Heat-resistant up to 300° C Resistant to impact Low friction coefficient

Max. total width B3 Tolerance ± 3.0 mm	147	197	247	297	347	397	447	497	547	597	647
Weight, kg/linear metre	4.6	5.6	6.6	7.7	8.7	9.7	10.8	11.8	12.8	13.9	14.9



Solid support of the KFS-P 2040.86
for conveying heavy loads



KFS-P 2040.86 for hot product with
resizeable supply reservoir



KF S-P 2040.86 head drive AC with
perforated hinged plate belt, transverse
cleats and burls for better product grip



KFS-P 2040.86 AF with two 45° inclines